

DISMANTLING

Remove the steering box.

Remove :

- the plunger cover
- setting washers.
- spring washer.
- spring and plunger.

Ease out the pinion cover.

Remove the pinion and rack.

Remove the circlip and outer thrust washer.

Tap the anti-knock bearing (1) out with a piece of tube 23 mm (.906") o/d.

Remove the inner thrust washer (if applicable).

Clean the bore.

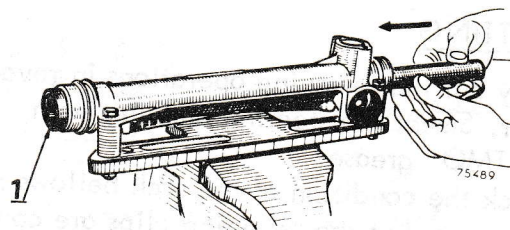
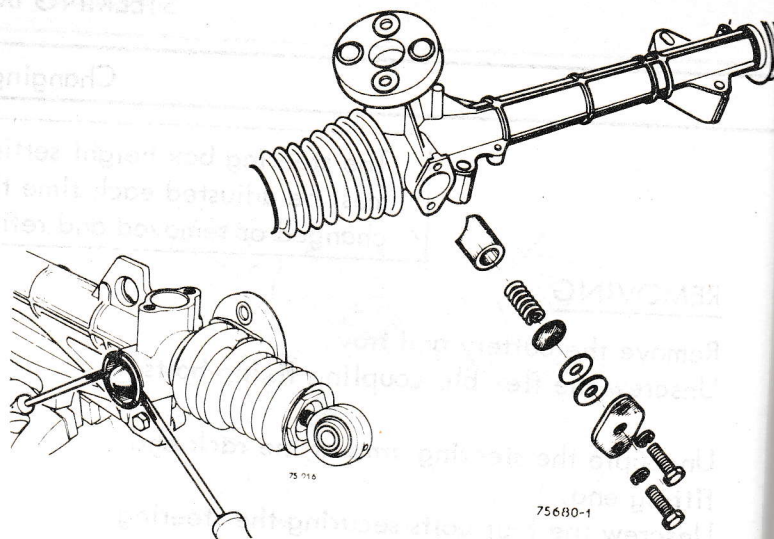

REASSEMBLING

Insert the following in order in the steering box :

- the inner thrust washer (for steering box, with bore (X) measuring 22,6 mm (7/64").
- the anti-knock bearing fitted with its two rubber bushes, using a mandrel made to drawing alongside.
- the outer thrust washer.

- the circlip.

Reassemble the steering box, spreading 40 cc of Molykote BR2 grease :

- on the pinion.
- rack.
- bearing.
- inside the cover.
- on the plunger and spring.
- on the plunger cover thrust face.

Refit the steering box and adjust the steering box height setting and parallelism.

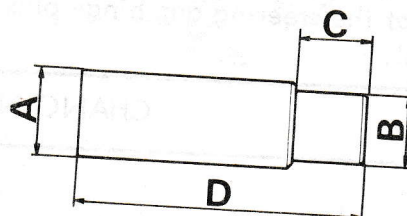

75491

Diameter A =	28 mm	(1.102")
B =	21 mm	(.827")
C =	25 mm	(63/64")
D =	100 mm	(3-15/16")

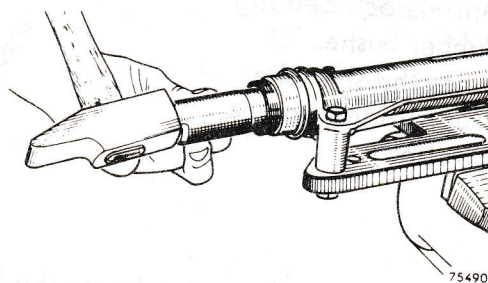

75490



3 136

ADJUSTING THE PLUNGER

Assessment of the adjusting washers needed for plunger clearance is made by taking into account the characteristics of :

- the rack
- plunger
- and steering box.

This method of adjustment must be followed when repair operations are carried out which might alter the plunger shim pack, for example in the case of knocking, so that the steering continues to function normally.